

SUZUKI MARINE OUTBOARD MOTORS

FULL LINE CATALOG



THE
ULTIMATE[™]
OUTBOARD MOTOR

SUZUKI CLEAN OCEAN PROJECT

As the world's ULTIMATE OUTBOARD MOTOR brand, Suzuki always remains focused on providing the ultimate marine experience, which requires a healthy and clean marine environment.

Since 2011, we have been voluntarily conducting the "Clean-Up the World Campaign" every year to contribute to a better marine environment and more than 19,000 people have participated. In Japan, the campaign has been officially recognized by the Ministry of the Environment in the "Plastic Smart Campaign".

To continue to make our utmost effort for environmental protection, it is now time for us to review how we have been contributing to the environment, society and determine our direction. As well as continuing our worldwide clean-up campaign, we will also commit to take responsible actions against plastic waste problems. This is how we came to create the new Slogan and Logo, "SUZUKI CLEAN OCEAN PROJECT", to show the world our commitment.

Our Commitment

1. Clean-Up the World Campaign
2. Reduce Plastic Packaging
3. Collect Marine Micro-Plastic Waste



We believe the actions Team Suzuki takes around the world will be one of the positive steps forward to a cleaner marine environment.

CONTENTS

- 4-5 **SUZUKI CLEAN OCEAN PROJECT**
- 6-11 **SUZUKI ULTIMATE TECHNOLOGY**
- 12-13 **STEALTH LINE™ SERIES**
 - DF350 STEALTH
 - DF300 STEALTH **NEW**
 - DF250A/DF250 STEALTH
 - DF200A/150A STEALTH
 - DF140B/115B STEALTH
- 14-15 **GEKI: 350-300HP FLAGSHIP**
 - DF350AMD/300BMD
 - DF350A/300B
- 16-17 **V6 300-200HP**
 - DF300AP/250AP
 - DF250/225/200
- 18-19 **IN-LINE 4 200-150HP**
 - DF200AP/175AP/150AP
 - DF200A/175A/150A
- 20-21 **IN-LINE 4 140-75HP**
 - DF140BG/115BG
 - DF140B/115B
 - DF90A/75A
- 22-23 **IN-LINE 3 60-25HP**
 - DF60AV/50AV
 - DF60A/50A/40A
 - DF30A/25A
- 24-25 **PORTABLE 20-2.5HP**
 - DF20A/15A/9.9B
 - DF6A/4A
 - DF2.5
- 26-28 **PARTS & ACCESSORIES**
- 29 **ECSTAR GENUINE OIL**
- 30-33 **SPECIFICATIONS & FEATURES**
- 34-35 **HISTORY**



SUZUKI CLEAN OCEAN PROJECT

In order to clean the ocean, the Suzuki Marine Team will promote the "SUZUKI CLEAN OCEAN PROJECT" together with partners and boaters all around the world.

To reduce marine plastic pollution, Suzuki has set up the slogan "CLEAN OCEAN PROJECT" and has been promoting the activities under the 3 commitments.

CLEAN-UP THE WORLD CAMPAIGN

More than **19,000** people from **94** groups participated in this activity.*



INDONESIA

PT SUZUKI INDOMOBIL SALES



SWEDEN

KGK MOTOR AB



AUSTRALIA

SUZUKI AUSTRALIA PTY. LTD.



SAUDI ARABIA

NAJEEB AUTO (MARINE)



HUNGARY

MAGYAR SUZUKI CORPORATION LTD.



EL SALVADOR

TRADER, S.A. DE C.V. *As of June, 2024



USA

SUZUKI MARINE USA, LLC

REDUCE PLASTIC PACKAGING

In order to avoid producing additional plastics, we have been replacing the plastic packaging of outboards and marine genuine parts to eco-conscious materials.

Packaging for Suzuki Marine genuine parts



■ Oct.2020 - June 2024 : Reduced **26.1t.**
Replacing the plastic packaging to biodegradable material.



- Sep 2021 - June 2024 : Reduced **41.1t.**
- ① **OPP Tape**
Polypropylene → Paper
- ② **Outer Fixing Band**
Polypropylene → Paper
- ③ **Ink (for all the ink on the carton)**
Animal-derived ink → Botanical Ink
- ④, ⑤ **Fixing Form**
Polystyrene Foam → 100% biomass-derived polymers
- ⑥ **Upper Engine Cover Sheet**
Nylon → Rayon
- ⑦ **Engine Cover Sheet**
Polypropylene → 100% biomass-derived polymers
- ⑧ **Inner Fixing Band**
Polypropylene → Paper

COLLECT MARINE MICRO-PLASTIC WASTE

As a solution to the plastics flowing into the oceans, which are not collected properly on land, Suzuki developed the world's first Micro-Plastic Collecting (MPC) device to install in select outboard motors.

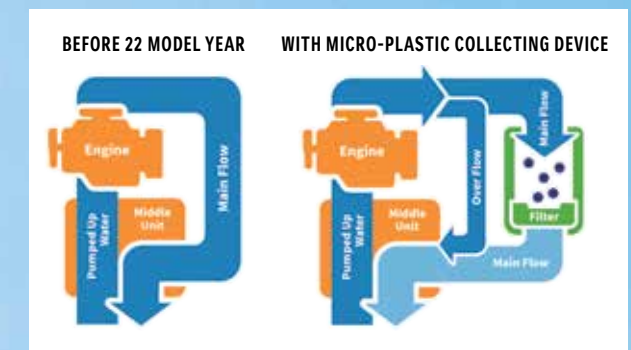
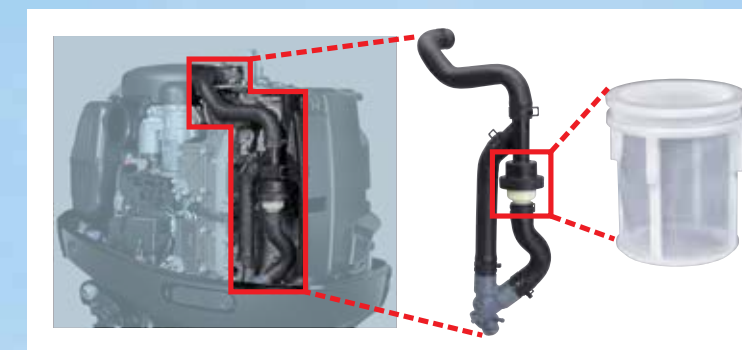

Garbage-contaminated seawater



Micro-Plastic Collecting device makes the sea beautiful



Collected materials

FEATURES

- Will not affect the performance of the engine even if the filter gets clogged since this device utilizes the used cooling water.
- Will not give negative effects on the environment.



STANDARD EQUIPMENT FOR THE
DF140BG / 115BG
DF140B / 115B

DF140BG
DF115BG
SUZUKI PRECISION CONTROL (S.P.C.) 2.0 with MPC

DF140B
DF115B
MECHANICAL with MPC



LEADING THE INDUSTRY WITH AWARD WINNING TECHNOLOGIES AND DESIGNS, SUZUKI OUTBOARDS PROVIDE FEATURES AND BENEFITS THAT MAKE BOATING EVEN MORE ENJOYABLE

Durability & Reliability	Performance	Ease & Comfort	Ecology & Economy
<ul style="list-style-type: none"> • Durable • Notifies user before engine trouble • Easy to service, repair <div style="display: flex; flex-wrap: wrap; justify-content: space-around;"> <div style="text-align: center; margin: 5px;"> DUAL LOUVER</div> <div style="text-align: center; margin: 5px;"> WATER DETECTING SYSTEM</div> <div style="text-align: center; margin: 5px;"> SELF-ADJUSTING TIMING CHAIN</div> <div style="text-align: center; margin: 5px;"> TILT LIMIT</div> <div style="text-align: center; margin: 5px;"> ANTI CORROSION</div> <div style="text-align: center; margin: 5px;"> DUAL WATER INLET</div> <div style="text-align: center; margin: 5px;"> SUZUKI SDSM</div> <div style="text-align: center; margin: 5px;"> SUB WATER INLET</div> <div style="text-align: center; margin: 5px;"> SDSM+</div> </div>	<ul style="list-style-type: none"> • Smooth and quick acceleration at all operating ranges • Powerful torque <div style="display: flex; flex-wrap: wrap; justify-content: space-around;"> <div style="text-align: center; margin: 5px;"> OFFSET DRIVESHAFT</div> <div style="text-align: center; margin: 5px;"> DUAL PROP</div> <div style="text-align: center; margin: 5px;"> MULTI-STAGE INDUCTION</div> <div style="text-align: center; margin: 5px;"> 2.50 GEAR RATIO</div> <div style="text-align: center; margin: 5px;"> HIGH ENERGY ROTATION</div> <div style="text-align: center; margin: 5px;"> VVT VARIABLE VALVE TIMING</div> <div style="text-align: center; margin: 5px;"> DIRECT INTAKE</div> </div>	<ul style="list-style-type: none"> • Less vibration • Quiet operation • Light & compact • Easy to use • Smooth and decisive shifting <div style="display: flex; flex-wrap: wrap; justify-content: space-around;"> <div style="text-align: center; margin: 5px;"> SELECTIVE ROTATION</div> <div style="text-align: center; margin: 5px;"> QUIET OPERATION</div> <div style="text-align: center; margin: 5px;"> PRECISION CONTROL</div> <div style="text-align: center; margin: 5px;"> THREE-WAY STORAGE</div> <div style="text-align: center; margin: 5px;"> OVERHEAD TANK</div> <div style="text-align: center; margin: 5px;"> TROLL MODE</div> <div style="text-align: center; margin: 5px;"> GAS ASSIST</div> <div style="text-align: center; margin: 5px;"> EASY START SYSTEM</div> <div style="text-align: center; margin: 5px;"> AUTOMATIC TRIM</div> <div style="text-align: center; margin: 5px;"> INTEGRATED STEERING SYSTEM</div> </div>	<ul style="list-style-type: none"> • Good fuel efficiency / low exhaust emissions • Low maintenance cost • Environmental protection activities <div style="display: flex; flex-wrap: wrap; justify-content: space-around;"> <div style="text-align: center; margin: 5px;"> LEAN BURN</div> <div style="text-align: center; margin: 5px;"> DUAL INJECTOR</div> <div style="text-align: center; margin: 5px;"> LESS BATTERY-LESS FUEL INJECTION</div> <div style="text-align: center; margin: 5px;"> CLEAN OCEAN PROJECT</div> </div>

Durability & Reliability



SUZUKI DUAL LOUVER SYSTEM

▶DF350AMD/300BMD ▶DF350 STEALTH ▶DF350A/300B

Dog-leg shaped dual louvers remove water from the air directed into the cowlings.

ADVANTAGE

- Prevents water intrusion.
- Allows a direct intake system, contributing to higher engine output.



SELF-ADJUSTING TIMING CHAIN

▶DF40A AND UP

The timing chain running in an oil-bath is adjusted automatically by hydraulic tensioner.

ADVANTAGE

- More durable than the belt type.
- Maintenance-free.



DUAL WATER INLET

▶DF350AMD/300BMD ▶DF350 STEALTH ▶DF350A/300B
▶DF300AP/250AP ▶DF300STEALTH ▶DF250A/250 STEALTH

The engine's cooling system relies on water supplied through two water inlets located on the lower unit.

ADVANTAGE

- Increases the water flow, providing better cooling performance.



WATER DETECTING SYSTEM

▶DF75A AND UP

A water detecting fuel filter system. When water is detected, the system will alert the driver with visual and audio warnings.

ADVANTAGE

- Helps prevent lower power output and corrosion by alerting driver of water intrusion.



TILT LIMIT SYSTEM

▶DF50AV AND UP
(not including DF50A/40A)

Tilt Limit System prevents the outboard from tilting beyond a selected angle.

ADVANTAGE

- Prevents damage to the boat or outboard due to excessive outboard tilting.

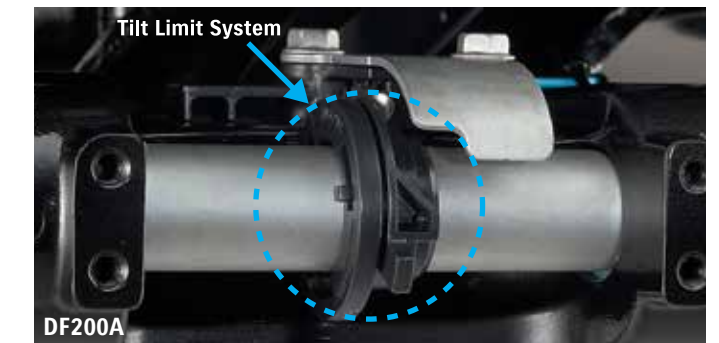

SUB WATER INLET

STANDARD: ▶DF60A/50A/40A

Two water inlets in different directions ensure that the engine does not overheat due to clogging by sea grass or algae.

NMMA Innovation Awards

The Innovation Awards (recognizing technological innovation) awarded each year by the NMMA (National Marine Manufacturers Association) are considered among the highest honor in marine technology. Of the new marine industry products in that year, they are awarded to "a product that shows technical leadership, is practical and cost-effective, and is truly beneficial to the consumer."

Starting with the DT200 Exanté in 1987 and extending to the DF350A in 2017, Suzuki outboard motors have received this Innovation Award a total of nine times. Eight of these awards are for 4-stroke outboard motors.



Awarded Prizes

1987: DT200 Exanté	2011: DF50A & DF40A
1997: DF70 & DF60	2012: DF300AP
1998: DF50 & DF40	2014: DF30A & DF25A
2003: DF250	2017: DF350A
2006: DF300	



KEYLESS START SYSTEM

OPTIONAL: ▶ DF350AMD/300BMD ▶ DF350 STEALTH ▶ DF350A/300B
▶ DF300AP/300 STEALTH/250AP ▶ DF250A/250STEALTH
▶ V6 DF250/225/200 ▶ DF200AP/175AP/150AP
▶ DF200A/175A/150A ▶ DF140BG/115BG
▶ DF140B/115B ▶ DF90A/75A

This system allows you to start multiple engines by placing a key-fob nearby.

- One push Start & Stop for up to 6 outboard motors.
- Waterproof Floating Key Fob.
- Security support with immobilizer.

ADVANTAGE

- Provides high security.
- Ignition key is not required.



SDSM+ (SUZUKI DIAGNOSTIC SYSTEM MOBILE+)

▶ DF9.9B AND UP*

Use the app to plan for boating by checking the weather forecast, the engine condition and operation tips. All functions are available for free.* Please check our website and page 28 for more details.

*SMD/SMG4 and a smartphone running Android/iOS are required.

ADVANTAGE

- Possible to make a plan for boat trip by checking the weather forecast in advance.
- Check up on the engines before the departure based on the engine data.
- Acquire the engine data by scanning the QR code*.
- Provide the engine data to dealer and ask for maintenance easily.

*DENSO WAVE owns the rights of the name and the logo of QR code.



SUZUKI ANTI-CORROSION FINISH

▶ ALL MODELS

Special protection is applied to the aluminum surface using high strength bonding to protect the aluminum made exterior parts.

ADVANTAGE

- Protection against corrosion helps increase the overall outboard durability.

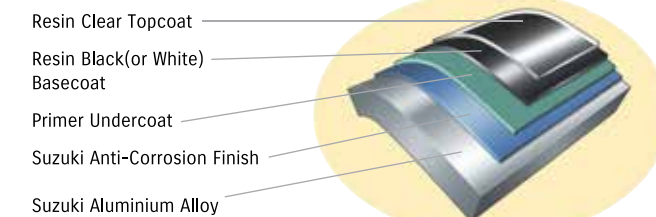

HIGH ENERGY ROTATION

▶ DF60AV/50AV

Larger lower units (2.42 gear ratio) make it possible to equip larger 36cm (14-inch) propeller than other models in this class. It offers better acceleration and more power.

ADVANTAGE

- Powerful torque to carry heavy loads.
- Quick acceleration with larger propellers.
- Quick and smooth planing.

DF60AV vs. DF60A size comparison

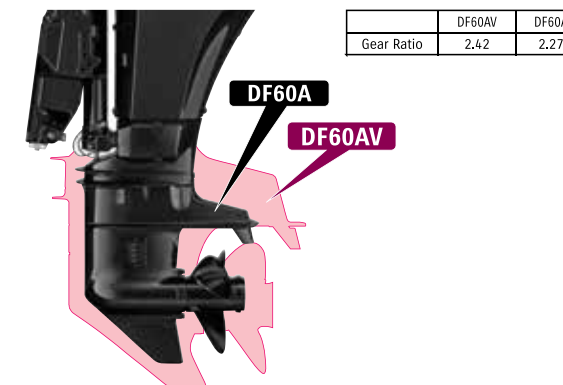

MULTI-STAGE INDUCTION

▶ DF250A/250 STEALTH ▶ DF250/225
▶ DF200AP/175AP/150AP ▶ DF200A/175A/150A

Intake manifold pipes are switched between short and long during low speed and high speed operation to ensure the right volume of air enters the engine.

ADVANTAGE

- Increases output during high speed operation with greater volume of air input.
- Increases combustion efficiency and maximizes torque during low speed operation.

AIR FLOW IN MULTI-STAGE INDUCTION MODULE

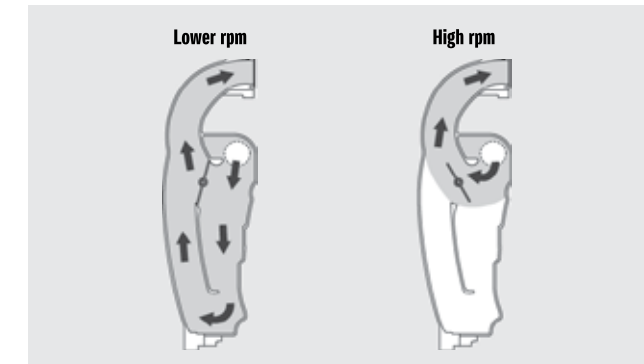

DIRECT AIR INTAKE

▶ DF350AMD/300BMD ▶ DF350 STEALTH ▶ DF350A/300B

A direct airflow path from the intake port to the cylinder suppresses temperature rise of the air and improves combustion efficiency.

ADVANTAGE

- Delivers higher power output from a small displacement.



SUZUKI DUAL PROP SYSTEM

▶ DF350AMD/300BMD ▶ DF350 STEALTH ▶ DF350A/300B

The Suzuki Dual Prop System spins two propellers rotating in opposite directions on a single lower unit. With the 6 blades, it can get a better grip on the water.

ADVANTAGE

- Achieve superior stability when driving straight.
- Powerful reverse thrust and braking force.
- Good water gripping performance and quick startup acceleration.

Performance



OFFSET DRIVESHAFT

▶ DF75A AND UP

The engine powerhead is positioned closer to the front, moving the outboard's center of gravity forward.

ADVANTAGE

- Less vibration
- More compact
- Stable steering performance

1st Stage Reduction : 30:36=1.20
2nd Stage Reduction : 12:25=2.08

Total : 2.50:1

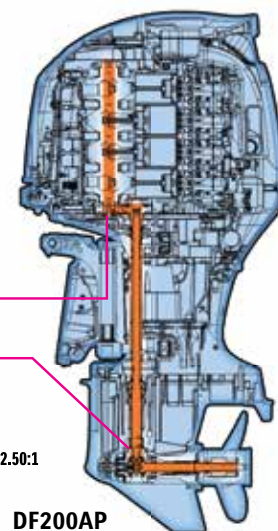

DF200AP



2-STAGE GEAR REDUCTION

▶ DF75A AND UP

This design makes a lower gear ratio possible, allowing it to turn a larger diameter higher pitch propeller.

ADVANTAGE

- Increased power to turn large diameter propellers, offering quick acceleration.
- High propulsive efficiency with large diameter propeller.
- Powerful navigation, maintaining propeller rotation even with a larger load.

GEAR RATIO IN EACH CLASS

MODEL	DF140BG/115BG DF140B/115B 90A/75A	DF200A(AP)/ 175A(AP)/150A(AP)	DF250/ 225/200	DF300AP/250AP DF300AP STEALTH DF250A DF250 STEALTH	DF350AMD/ 300BMD DF350 STEALTH DF350A/300B
GEAR RATIO	2:59:1	2:50:1	2:29:1	2:08:1	2:29:1



VVT (Variable Valve Timing)

▶ DF350AMD/300BMD ▶ DF350 STEALTH ▶ DF350A/300B
▶ DF300AP/250AP ▶ DF300 STEALTH ▶ DF250A/250 STEALTH
▶ DF200AP/175AP/150AP ▶ DF200A/175A/150A

The Variable Valve Timing controls the opening and closing timing of the intake valves depending on the engine RPM.

ADVANTAGE

- Offers smooth, powerful torque.
- Provide smooth acceleration across all speed ranges.

TORQUE CURVE

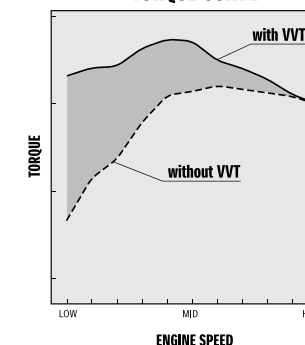

Ease & Comfort



SUZUKI SELECTIVE ROTATION

▶DF300AP/250AP ▶DF300 STEALTH ▶DF200AP/175AP/150AP

Function for selecting regular or counter rotation on one outboard with an optional connector and a counter rotation propeller.

ADVANTAGE

- Either regular or counter rotation can be used on the same outboard.



THREE-WAY STORAGE

▶DF6A/4A

The design allows the outboard to be removed from the boat and placed on any of its 3 sides for storage.

ADVANTAGE

- No need to worry about the loading space or method.



SUZUKI PRECISION CONTROL (S.P.C.) 2.0 (Electronic Throttle and Shift Systems)

▶DF350AMD/300BMD ▶DF350 STEALTH ▶DF350A/300B
▶DF300AP/250AP ▶DF300 STEALTH ▶DF250A STEALTH
▶DF200AP/175AP/150AP ▶DF140BG/115BG

Operation from the remote control is delivered to the outboard via an electric signal and it enables 1 lever operation for up to 6 outboard motors (for dual mount only).

ADVANTAGE

- Reduced friction and resistance compared to the mechanical controls.
- Easy control for multiple outboard motors.
- Improved fuel economy with the combination of Lean Burn Control System.



OVERHEAD TANK

▶DF6A/4A/2.5

The integral overhead fuel tank and one-way valve delivers fuel supply by using gravity.

ADVANTAGE

- Contributes to easy start.



AUTOMATIC TRIM*

▶ 115HP and Up

The Auto Trim feature adjusts the trim angle automatically depending on the engine RPM.

Note: Auto trim is only available on SPC 2.0 engines or 2023 and newer mechanical engines (75hp and up) with CanBus harness.



NOISE REDUCTION

▶DF350AMD/DF300BMD ▶DF350 STEALTH ▶DF350A/300B
▶DF200AP/175AP/150AP ▶DF200A/175A/150A
▶DF140BG/115BG ▶DF140B/115B

Intake noise is reduced with silencer and resonator.

ADVANTAGE

- Less noise, makes boating more enjoyable.

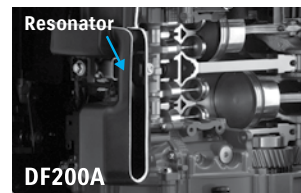

SUZUKI TROLL MODE SYSTEM*

▶DF40A AND UP
Optional for Remote Control Models

This system helps the boat running at a certain speed range in low RPM.

ADVANTAGE

- Boat can keep running at a certain speed range in low RPM without having to operate the throttle on the boat.
- Gives you precise control at low RPM.

*Available with SMD, SMG4, or Troll Mode Switch Panel



SUZUKI EASY START SYSTEM

▶DF40 AND UP

Simply turn the key and release, and the starter stays engaged until the engine starts. This system offers a smoother start of the engine.



INTEGRATED STEERING SYSTEM

▶DF350AMD/300BMD ▶DF350 STEALTH

The conventional external hydraulic cylinder is built into the outboard motor.

ADVANTAGE

- Simple appearance of the motorwell when rigging.
- Allows rigging to various types of boats.
- Easy rigging.

Ecology & Economy



BATTERY-LESS ELECTRONIC FUEL INJECTION

▶DF30A/25A ▶DF20A/15A/9.9B

This technology delivers quicker start, smoother operation, and more acceleration without a battery.

ADVANTAGE

- Operates without battery.
- Quick and easy start.
- Cleaner and economic fuel consumption.
- Higher and smoother performance in almost all operating ranges.



DUAL INJECTOR

▶DF350AMD/300BMD ▶DF350 STEALTH ▶DF350A/300B

The dual injectors deliver just the right amount of fuel at just the right time into each cylinder.

ADVANTAGE

- Contributes to higher output and better fuel efficiency.



LEAN BURN CONTROL SYSTEM

LEAN BURN
▶DF9.9B AND UP
(not including V6 DF250/225/200)

The Lean Burn Control System supplies the appropriate amount of fuel and air mixture depending on the navigation conditions.

ADVANTAGE

- Significant improvement in fuel economy in all speed ranges especially at cruising speed.
- Fuel is saved and gasoline costs are lowered.

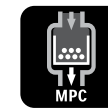

MICRO-PLASTIC COLLECTING DEVICE

▶DF140BG/115BG ▶DF140B/115B ▶DF140B/115B STEALTH

As one of the actions in SUZUKI CLEAN OCEAN PROJECT, we developed the device to collect micro-plastics in the oceans just by running a SUZUKI outboard motor.

ADVANTAGE

- Collect micro-plastics through your outboard motors.
- No sacrifice to the engine performance.

STEALTH LINE OUTBOARD MOTORS

NEW

DF350 STEALTH / DF300 STEALTH / DF250A STEALTH / DF250 STEALTH / DF200 STEALTH / DF150 STEALTH / DF140B STEALTH / DF115B STEALTH

STEALTH LINE™



DF350

DF300

DF250A

DF250



DF200A

DF150A

DF140B

DF115B

The Stealth Line Outboard won the 2024 Top Products Award from Boating Industry Magazine for honoring customers and builders demands with an innovative, stylish, bold look.

GOT THE LOOK

DF350 DF300 DF250A

SUZUKI PRECISION CONTROL (S.P.C.) 2.0

DF250

DF200A / DF150A, DF140B / DF115B

MECHANICAL

BOLD STYLISH QUIET

MATTE BLACK

The "ONE" is characterized by quiet yet robust performance, exhibiting exceptional endurance. Suzuki outboard engines have consistently been described in these terms. Now, the external design of our engines aligns with the high standards set by this renowned engine series.

CHROME BLACK GRAPHICS

Introducing the bold new STEALTH LINE™ of engines from Suzuki Marine, featuring distinctive style lines, a sleek matte black finish, and uncompromising performance. This new lineup solidifies Suzuki Marine as the ultimate choice for outboard motors.

Durability & Reliability

ANTI CORROSION ALL MODELS	DUAL LOUVER DF350	DUAL WATER INLET DF350 DF300 DF250A	SELF-ADJUSTING TIMING CHAIN ALL MODELS	WATER DETECTING SYSTEM ALL MODELS	TILT LIMIT ALL MODELS	KEYLESS START SYSTEM (OPTIONAL*1)	SDSM+ (OPTIONAL)	DUAL INJECTOR DF350	LEAN BURN ALL MODELS	MPC DF140B DF115B
------------------------------	----------------------	--	---	--------------------------------------	--------------------------	--------------------------------------	---------------------	------------------------	-------------------------	-------------------------



Performance

2.29 GEAR RATIO DF350	2.08 GEAR RATIO DF300 DF250A	OFFSET DRIVESHAFT ALL MODELS	VARIABLE VALVE TIMING DF350 DF300 DF250A DF250 DF200A	DUAL PROP DF350AMD
2.50 GEAR RATIO DF200A DF150A	2.59 GEAR RATIO DF140B DF115B	MULTI-STAGE INDUCTION DF250 DF200A DF150A		

Ease & Comfort

SELECTIVE ROTATION DF300	PRECISION CONTROL DF350 DF300 DF250A	TROLL MODE (OPTIONAL*2)	EASY START SYSTEM ALL MODELS	NOISE REDUCTION DF350 DF200A DF150A DF140B DF115B	INTEGRATED STEERING SYSTEM DF350	AUTOMATIC TRIM (OPTIONAL)*2
-----------------------------	---	----------------------------	---------------------------------	--	-------------------------------------	--------------------------------

*1 Available with SMG4

*2 Available with SMG4, or Troll Mode Switch Panel

SPECIFICATIONS / FEATURES P30-32

V6 350-300HP Flagship - GEKI Series

◆ S.P.C 2.0 DF350AMD / DF300BMD / DF350A / DF300B

THE **ULTIMATE**
OUTBOARD MOTOR



SUZUKI DUAL LOUVER SYSTEM

Dual Louver system is designed to remove water from the air taken into the cowl.

Incorporating a direct intake system makes the highest compression ratio of 12.0:1(DF350AMD,DF350A), 10.5:1(DF300BMD, 300B) possible, ultimately leading to a higher engine output.



DUAL WATER INLET

The engine's cooling system relies on water supplied through low water intakes located on the lower unit. This dual water inlet configuration increases water flow into the lower unit, delivering greater cooling efficiency.



SUZUKI DUAL PROP SYSTEM

The dual prop system efficiently transmits the horsepower into propulsion. As an added benefit, because each propeller rotates in the opposite direction, exceptional stability is achieved.

In addition, the contra-rotating propellers produce a strong reverse thrust.



DUAL INJECTOR

Dual injectors deliver just the right amount of fuel at just the right time into the cylinder.

This dual injector contributes to higher output and better fuel efficiency.



DF350AMD/ DF300BMD

DF350A/DF300B

SUZUKI PRECISION CONTROL (S.P.C.) 2.0



GEKI: PARTING SEAS

A Force to Match the Power of Nature and the Sea Representing Suzuki's Identity and Heritage. A Symbol of Our Passion and Commitment to the Ultimate in Marine Innovation.

"GEKI: PARTING SEAS" is the logo that represents the DF350AMD/DF300BMD, DF350A/DF300B

Durability & Reliability



Ecology & Economy

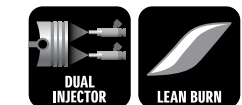

Performance



Ease & Comfort

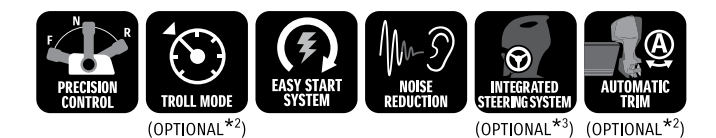

*1 Available with SMG4

*2 Available with SMG4, or Troll Mode Switch Panel

*3 DF350AMD/300BMD

SPECIFICATIONS / FEATURES P30

V6 300-200HP

- ◆ S.P.C 2.0 DF300AP / DF250AP
- ◆ Mechanical DF250 / DF225 / DF200

THE **ULTIMATE**
OUTBOARD MOTOR



DF300AP

DF250AP



SUZUKI PRECISION CONTROL (S.P.C.) 2.0

DF250

DF225 / DF200

MECHANICAL



STANDARD FEATURES

Durability & Reliability

ANTI CORROSION ALL MODELS	SELF-ADJUSTING TIMING CHAIN ALL MODELS	WATER DETECTING SYSTEM ALL MODELS	TILT LIMIT ALL MODELS	SDSM+ (OPTIONAL*1) ALL MODELS

Performance

2.29 GEAR RATIO DF250 DF225 DF200	2.08 GEAR RATIO DF300AP DF250AP	OFFSET DRIVESHAFT ALL MODELS	VARIABLE VALVE TIMING DF300AP DF250AP DF250	MULTI-STAGE INDUCTION DF250 DF225

ADDITIONAL FEATURES FOR SUZUKI PRECISION CONTROL (S.P.C.) 2.0 MODEL

Durability & Reliability

DUAL WATER INLET DF300AP DF250AP	KEYLESS START SYSTEM (OPTIONAL) ALL MODELS

Ease & Comfort

SELECTIVE ROTATION DF300AP DF250AP	PRECISION CONTROL DF300AP DF250AP	TROLL MODE (OPTIONAL*2) ALL MODELS	EASY START SYSTEM ALL MODELS	AUTOMATIC TRIM (OPTIONAL *2)

Ecology & Economy

LEAN BURN DF300AP DF250AP

*1 Available with SMG4 *2 Available with SMG4 or Troll Mode Switch Panel *3 Available for Mechanical using the CAN mechanical harness

IN-LINE 4 200-150HP

- ◆ S.P.C. 2.0 DF200AP / DF175AP / DF150AP
- ◆ Mechanical DF200A / DF175A / DF150A

THE **ULTIMATE™**
OUTBOARD MOTOR



DF200AP

DF175AP / DF150AP

SUZUKI PRECISION CONTROL (S.P.C.) 2.0

DF200A

DF175A/DF150A

MECHANICAL

SUZUKI PRECISION CONTROL (S.P.C.) 2.0 (ELECTRONIC THROTTLE AND SHIFT SYSTEMS)

FEATURES

Operation from the remote control is delivered to the outboard motor via an electric signal and it enables the one lever operation for up to 6 outboard motors (for dual mount only).



SUZUKI SELECTIVE ROTATION

P10



Function for selecting standard or counter rotation on one outboard with an optional connector.

NOISE REDUCTION

P10

Intake noise is reduced with a resonator, that lowers sound levels and improves the boating experience.

STANDARD FEATURES

Durability & Reliability

- ANTI CORROSION (ALL MODELS)
- SELF-ADJUSTING TIMING CHAIN (ALL MODELS)
- WATER DETECTING SYSTEM (ALL MODELS)
- TILT LIMIT (ALL MODELS)
- SDSM+ (OPTIONAL*1) (ALL MODELS)
- KEYLESS START SYSTEM (OPTIONAL) (ALL MODELS)

Performance

- OFFSET DRIVESHAFT (ALL MODELS)
- 2.50 GEAR RATIO (ALL MODELS)
- MULTI-STAGE INDUCTION (ALL MODELS)
- VVT VARIABLE VALVE TIMING (Not including DF150A)

Ease & Comfort

- NOISE REDUCTION (ALL MODELS)
- TROLL MODE (OPTIONAL*2) (ALL MODELS)
- EASY START SYSTEM (ALL MODELS)
- AUTOMATIC TRIM (OPTIONAL*2)

ADDITIONAL FEATURES FOR SUZUKI PRECISION CONTROL (S.P.C.) 2.0 MODEL

Ease & Comfort

- SELECTIVE ROTATION (DF200AP, DF175AP, DF150AP)
- PRECISION CONTROL (DF200AP, DF175AP, DF150AP)

Ecology & Economy



LEAN BURN (ALL MODELS)

*1 Available with SMG4 *2 Available with SMG4, or Troll Mode Switch Panel

SPECIFICATIONS / FEATURES P30-31

IN-LINE 4 140-75HP

- ◆ S.P.C. 2.0 DF140BG / DF115BG
- ◆ Mechanical DF140B / DF115B / DF90A / DF75A



**DF140BG
DF115BG**

SUZUKI PRECISION CONTROL (S.P.C.) 2.0

with MPC



**DF140B
DF115B**

MECHANICAL

with MPC

■ Tiller handle model available for DF115B



**DF90A
DF75A**

MECHANICAL

■ Tiller handle model available (For 90HP & 75HP)

THE **ULTIMATE**
OUTBOARD MOTOR

COLLECT MARINE MICRO-PLASTIC WASTE

As a solution to the plastics flowing into the oceans, which are not collected properly on land, Suzuki developed the world's first Micro-Plastic Collecting (MPC) device installed on outboard motors.



BEFORE 22 MODEL YEAR WITH MICRO-PLASTIC COLLECTING DEVICE

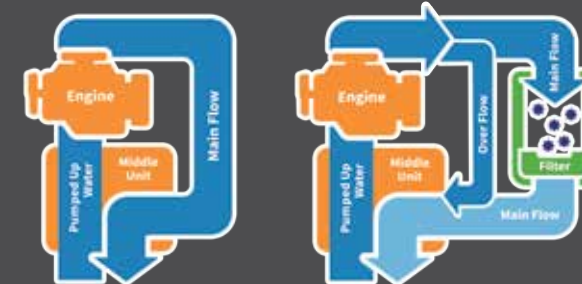

FEATURES

- Will not affect the performance of the engine even if the filter gets clogged since this device utilizes the used cooling water.
- Will not negatively affect the environment.

Garbage-contaminated seawater



Microplastic collector makes the sea beautiful



Collected materials

STANDARD FEATURES

Durability & Reliability

- ANTI CORROSION ALL MODELS
- SELF-ADJUSTING TIMING CHAIN ALL MODELS
- WATER DETECTING SYSTEM ALL MODELS
- TIPT LIMIT ALL MODELS
- SDSM+ (OPTIONAL*) ALL MODELS
- SUB WATER INLET (OPTIONAL) ALL MODELS
- KEYLESS START SYSTEM (OPTIONAL) ALL MODELS

Ease & Comfort

- TROLL MODE (OPTIONAL*) REMOTE CONTROL MODELS (STANDARD) TILLER HANDLE MODELS
- EASY START SYSTEM ALL MODELS
- NOISE REDUCTION DF140BG/DF115BG, DF140B/DF115B
- AUTOMATIC TRIM (OPTIONAL*) DF140BG/115BG, DF140B/115B
- OFFSET DRIVESHAFT ALL MODELS
- GEAR RATIO 2.59 ALL MODELS
- LEAN BURN ALL MODELS
- MPC DF140BG/DF115BG, DF140B/DF115B

ADDITIONAL FEATURES FOR SUZUKI PRECISION CONTROL (S.P.C.) 2.0 MODEL

Ease & Comfort

- PRECISION CONTROL DF140BG, DF115BG

*1 Available with SMG4 *2 Available with SMG4, or Troll Mode Switch Panel

SPECIFICATIONS / FEATURES **P32**

IN-LINE 3 60-25HP

DF60AV / DF50AV
DF60A / DF50A / DF40A
DF30A / DF25A

THE **ULTIMATE**
OUTBOARD MOTOR



DF60AV
DF50AV

HIGH ENERGY ROTATION

■ Tiller handle available

DF60A
DF50A / DF40A

■ Tiller handle available

STANDARD FEATURES

Durability & Reliability

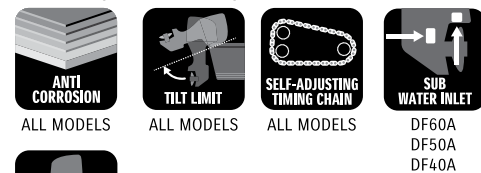

Performance Ease & Comfort

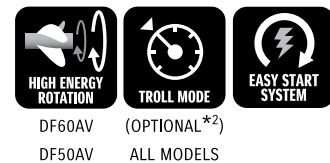

*1 Available with SMG4
*2 Available with SMG4, or Troll Mode Switch Panel

Ecology & Economy

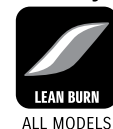

DF30A
DF25A

BATTERY-LESS EFI

■ Remote Control model available
■ Power Trim and Tilt available



HIGH ENERGY ROTATION

These outboards are equipped with a 2.42 gear ratio, which is larger than the standard model. When combined with a large 36cm (14-inch) propeller, the system can deliver powerful thrust. This is ideal for heavy boats.

ADVANTAGE

- Powerful propulsion and precise maneuvering, even with heavy loads.
- Superior power to turn large diameter propellers.

DF60AV vs. DF60A size comparison

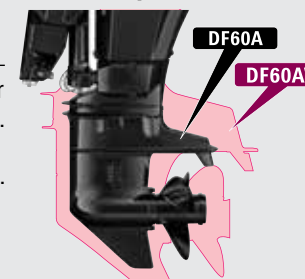

	DF60AV	DF60A
Gear Ratio	2.42	2.27



SELF-ADJUSTING TIMING CHAIN

The timing chain running in an oil-bath is adjusted automatically by a hydraulic tensioner.

ADVANTAGE

- More durable than the belt type.
- Maintenance-free.



BATTERY-LESS ELECTRONIC FUEL INJECTION

P11

This technology delivers quick start, smooth operation, and strong acceleration without a battery.

TROLL MODE + SMG4

P30



Allows you to control your troll mode from the Multi-Function Gauge.

STANDARD FEATURES

Durability & Reliability

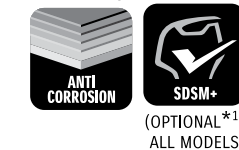

Ecology & Economy



*1 Available with SMG4

SPECIFICATIONS / FEATURES P32-33

PORTABLE 20-2.5HP

DF20A / DF15A / DF9.9B
DF6A / DF4A
DF2.5



DF20A

DF15A / DF9.9B

BATTERY-LESS EFI

- Remote control model available
- Power Tilt available
- Electric Start available



DF6A

DF4A

THREE-WAY STORAGE



DF2.5

THE **ULTIMATE**
OUTBOARD MOTOR



INTEGRAL OVERHEAD FUEL TANK

The integral overhead fuel tank and one-way valve delivers fuel supply using gravity.

THREE-WAY STORAGE



The design allows the outboard to be removed from the boat and placed on any of its 3 sides for storage.

STANDARD FEATURES

Durability & Reliability



ANTI CORROSION



SDSM+

ALL MODELS (OPTIONAL *1)
DF20A
DF15A
DF9.9B

Ease & Comfort



THREE-WAY STORAGE

DF6A
DF4A



OVERHEAD TANK

DF6A
DF4A

Ecology & Economy



LEAN BURN

DF20A
DF15A
DF9.9B



BATTERY-LESS FUEL INJECTION

LESS
DF20A
DF15A
DF9.9B

*1 Available with SMG4

SUZUKI MULTI-FUNCTION GAUGE (SMG4) ▶ DF9.9B AND UP

Suzuki Multi-Function Gauge provides all performance information on one gauge. Individual elements can also be emphasized to further enhance user friendliness.

SMG4



DAY MODE



NIGHT MODE

FEATURES



MULTI-LINGUAL MENU



AUTOMATIC TRIM FUNCTION



Automatically adjusts trim angle.

ANALOG TACHO & SPEED MODE

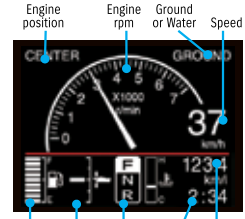

TROLL MODE



SPECIFICATIONS

- 3.5 Color Display
- Size: 4.13 in. (W) x 4.13 in. (H) x 0.63 in. (D)
- NMEA2000 output
- Shows both digital and analog readouts, as well as day/night mode
- Displays the QR code* for SDSM / SDSM+
- Troll Mode Function: Allows user to control troll mode (only for 2019MY and newer models adapted to troll mode)

English, French, Italian, German, Spanish, Swedish, Norwegian, Finnish, Dutch, Portuguese, Danish, Russian, Japanese

* DENSO WAVE owns the rights of the name and the logo of QR code.

SMD7 AND SMD9 FURUNO MULTI-FUNCTION DISPLAYS



SMD9



SMD7

With the Multi-Function Display your boat and engine can now be connected to global weather and be in touch with your surrounding environment as well as control and operate all your other devices on your boat. Control at the touch of a finger with the touch screen glass top design.

WATERGRIP PROPELLER

WATERGRIP is a stainless-steel propeller series offering accurate response to your operation. This propeller series efficiently converts engine power into propulsion, and meets our customers' demand for bigger, faster, more powerful outboards.

The WATERGRIP propeller series employs a new interchangeable and square shaped propeller bushing that minimizes power loss in delivery.



WATERGRIP

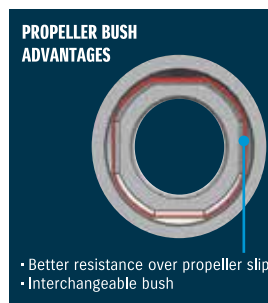

- Better resistance over propeller slip
- Interchangeable bush



WATERGRIP DUAL

MULTI-FUNCTION TILLER HANDLE ▶ DF115B ▶ DF75A/90A ▶ DF60A/50AV/60AV ▶ DF40A/50A

Main features



Tachometer with warning indicators



Three-position angle adjustable bracket



Troll mode switch Activates SUZUKI Troll Mode System and controls RPM from idling engine speed up to 1200rpm at every 50rpm.



Power trim & tilt switch and throttle grip friction adjuster

SUZUKI PRECISION CONTROL (S.P.C.) 2.0

▶ DF350AMD/300BMD ▶ DF350 STEALTH ▶ DF350A /300B ▶ DF300AP/250AP ▶ DF300 STEALTH ▶ DF250A STEALTH ▶ DF200AP/175AP150AP ▶ DF140BG/115BG

Suzuki's best technology lies in the Suzuki Precision Control (S.P.C.)2.0 System. The S.P.C. enables instant, precise throttle response for greater control and accuracy.

FEATURES

- Control up to 6 outboard engines.
- Sequential start for multi-engine boats: Engines start in order from port to starboard.
- Automatic Trim is available with SMD or SMG4.
- 1 Lever Operation: This switch allows multiple engine operation with just 1 lever. (Dual top mount only)
- Integrated Emergency Switch (Flush Mount only)



Find out more from our video

REMOTE CONTROL BOX

Integrated "Select" and "Throttle Only" switch (All)



SUZUKI BINNACLE

DUAL BINNACLE

FLUSH MOUNT BINNACLE

CONTROL PANEL



SWITCH PANEL FOR STANDARD KEY



KEYLESS START SYSTEM*

- ▶ All S.P.C. models
- ▶ Available for all Mechanical models DF75-Up using the CAN Mechanical Harness

How to use

1. Stand nearby the console with the key fob.
2. Push START/STOP button to start engine.
3. To turn off the engine, push the button again.

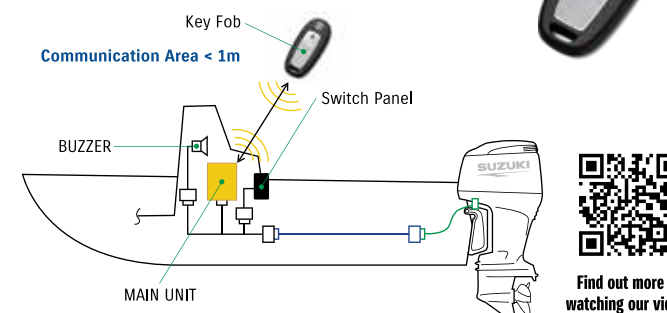

Find out more by watching our videos

*Please check applicability with your local Suzuki dealer.

FEATURES

- 3 types of panels are available: Vertical, Horizontal and Individual.
- 1-push Start/Stop, and controls up to 6 engines. No ignition key necessary.



MAINTENANCE KITS

Suzuki provides maintenance kits for quick and reliable service. Each kit comes with all the specific maintenance parts necessary for your model.



Please consult your local Suzuki dealer for the contents of each kit and applicable models.



PARTS & ACCESSORIES

SUZUKI DIAGNOSTIC SYSTEM MOBILE PLUS (SDSM+)

DF9.9B AND UP
*Available with SMG4

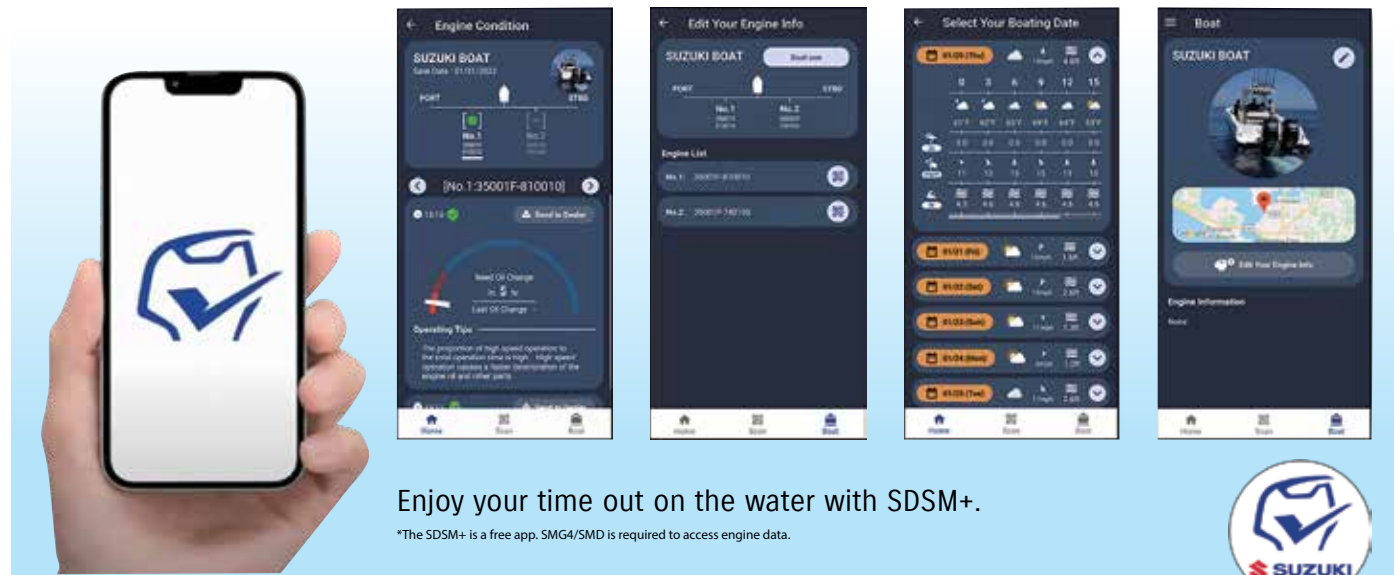

Enjoy your time out on the water with SDSM+.

*The SDSM+ is a free app. SMG4/SMD is required to access engine data.



3 FEATURES OF THE SDSM+

1. PLAN A BOAT TRIP WITH THE FORECAST

- + You can make a boating plan and refer to the weather, wind, and wave condition at a designated point.
- + The app also shows the weekly weather forecast, which is constantly updated.

2. INSPECT BOAT AND OUTBOARD MOTOR IN ADVANCE

- + Outboard motor can be checked based on the engine data.
- + You can share engine data with your dealer, which can shorten the service time.

3. ACQUIRE ENGINE DATA

- + You can check the engine condition and your driving tendencies.
- + You can provide engine data to your dealer, to check engine maintenance reminders.



Apple and the Apple logo are trademarks of Apple Inc., registered in the U.S. and other countries. App Store is a service mark of Apple Inc., registered in the U.S. and other countries.

Google Play and the Google Play logo are trademarks of Google LLC.

HOW TO GET THE ENGINE DATA

1. The outboard will convert engine data into a QR code* displayed on the SMG4 or SMD.
2. Open the app and scan the QR code. The app will receive the engine data and automatically attach it to an e-mail.
3. You can then send the e-mail to your nearby dealer to shorten the maintenance time.



Find out more at our Global Website

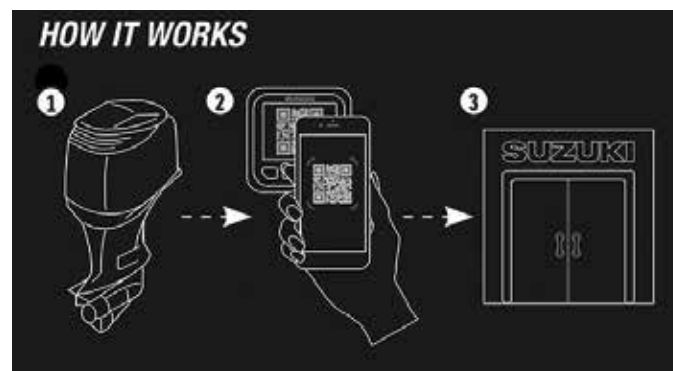

ECSTAR

GENUINE OIL AND CHEMICAL

What is ECSTAR

ECSTAR is a global brand name of SUZUKI Genuine Oil and Chemicals.

The ULTIMATE Formulation

Suzuki Approved Genuine engine oils have all been rigorously tested and certified by Suzuki engineers. You can be confident that they'll help keep your Suzuki outboard in perfect condition, giving you maximum performance and reliability over its lifetime.

ECSTAR Line up for OUTBOARD MOTORS

ENGINE OIL
SEMI SYNTHETIC V7000

GEAR OIL
SAE90

WATER RESISTANT
GREASE



Availability may differ in some regions. Please contact your Suzuki local dealer.

Continuously evolving over the decades, Suzuki has a rich, proud history knowing no bounds.

SUZUKI A HISTORY OF OUTBOARD INNOVATION

*Yamanaka Spirit
Let's give it a try.*

Year	Model	Key Innovation / Award
1965	D55	SUZUKI'S FIRST OUTBOARD MOTOR
1974	DT25	EARLY OIL INJECTION ENGINES
1980	DT85	
1987	DT200 EXANTE	WINNER, NMMA MOST INNOVATIVE PRODUCT AWARD
1997	DF70	INDUSTRY-FIRST 4-STROKE WITH EFI NMMA INNOVATION AWARD WINNER
2006	DF300	INDUSTRY-FIRST V6 300 HP 4-STROKE NMMA INNOVATION AWARD WINNER
2008	DF90/70	INTRODUCTION OF OUR INNOVATIVE LEAN BURN CONTROL SYSTEM
2014	DF200AP	DF200 ADOPTS SUZUKI SELECTIVE ROTATION AND DELIVERS BIG BLOCK PERFORMANCE FROM AN INLINE 4 ENGINE
2017	DF350A	FIRST OUTBOARD CONTRAROTATIONAL DUAL PROP SYSTEM NMMA INNOVATION AWARD WINNER
2020	DF115/140BG	DF115/140BG FIRST IN HP CLASS ALL-DIGITAL ENGINES SELECTED BOATING INDUSTRY'S TOP PRODUCTS OF 2021
2024	STEALTH	SUZUKI INTRODUCES AND EXPANDS A NEW STYLE AND APPEARANCE THAT EMBODIES QUIET, STRONG PERFORMANCE AND EXCEPTIONAL ENDURANCE SELECTED BOATING INDUSTRY'S TOP PRODUCTS OF 2024



Please read your Owner's Manual carefully. Remember, boating and alcohol or other drugs don't mix. Always wear a personal flotation device when boating. Please operate your outboard safely and responsibly.

Suzuki encourages you to operate your boat safely and with respect for the marine environment.

Specifications, appearances, equipment, colors, materials and other items of "SUZUKI" products shown in this catalogue are subject to change by manufacturers at any time without notice and they may vary depending on local conditions or requirements. Each model might be discontinued without notice. Please inquire at your local dealer for details of any such changes. Actual body color might differ from the colors in this brochure.



Suzuki Marine USA, LLC
13521 Prestige Pl.
Tampa, FL 33635-2529
www.suzukimarine.com

FULL LINE CATALOG
99953-25501
Printed in the U.S.A.
PV062025



suzukimarine.com

©2025 Suzuki Marine USA, LLC. All rights reserved.